



ALTA
WINDOW FASHIONS
design simplified

ALUMINUM BLINDS

Pricing effective May 13, 2024 and supersedes all previous pricing.
Subject to change by Alta Window Fashions.

Revised 7/1/24

SUMMARY OF REVISIONS

7-1-24 Revisions:

Pages 3, 4 and 5Added Cordless Lift and Lock to header
Page 8.....Cordless Lift & Lock Bottomrail Color Coordination chart added

TABLE OF CONTENTS

Features And Options

- Color Chart. 2

Pricing Information

- Price Chart and Option Charges. 3-5

Product Information

- Features and Options. 6
- Product Specifications 7
- Cordless Lift & Lock™ Bottomrail Color Chart. 8

Product Components Guide – product components pages are now featured in a separate guide for quick reference. [Click here to view.](#)

Oversize Common Carrier Delivery

All orders with any quantity of shades or blinds or any continuous valance 90" or more in width are considered oversize. Therefore, a net shipping charge per oversized unit will be assessed.

Oversized orders that require expedited shipping will be quoted and charged accordingly.

Please see General Information for additional freight and shipping charge information.

COLOR CHART

**Essentials
Collection**

**Prime
Collection**

**Macro
Collection**

SOLID FINISHES			
COLOR NAME	1" .006 GAUGE	1" .008 GAUGE	2" .008 GAUGE
Alabaster	G6-002	G8-002	M2-002
Antique	G6-973	G8-973	M2-973
Beige	G6-186	G8-186	-
Black	G6-048	G8-048	M2-048
Canvas	G6-830	G8-830	M2-830
Cashmere	G6-997	G8-997	-
Chalk White	G6-885	G8-885	M2-885
Dark Bronze	G6-994	G8-994	M2-994
Evening Snow	-	G8-385	-
Malibu Sand	G6-316	G8-316	-
Mercury	G6-276	G8-276	M2-276
Mushroom	G6-365	G8-365	M2-365
Pearl	G6-974	G8-974	M2-974
Pebble	G6-999	G8-999	-
Pewter Gray	G6-405	G8-405	-
Polar Bear	G6-116	G8-116	M2-116
Pure White	G6-125	G8-125	-
Raw Umber	G6-887	G8-887	M2-887
Sand	G6-310	G8-310	M2-310
Seattle Gray	G6-860	G8-860	-
Smokey Gray	G6-443	G8-443	-
Squirrel Gray	G6-998	G8-998	M2-998
U.N. Gray	-	G8-870	M2-870
Vanilla	-	G8-148	M2-148
White	G6-990	G8-990	M2-990
White Cap	G6-113	G8-113	-

PREMIUM FINISHES			
COLOR NAME	1" .006 GAUGE	1" .008 GAUGE	2" .008 GAUGE
Bright Aluminum	G6-190	G8-190	M2-190
Brushed Aluminum	G6-034	G8-034	M2-034
Brushed Aluminum Perforated	-	G8-034P	-
Brushed Nickel Texture	-	G8-262	-
Brushed Patina	G6-996	G8-996	-
Café Noir	G6-993	G8-993	-
Champagne Mist	-	G8-995	-
China Blue	G6-637	G8-637	-
Copperite	-	G8-915	-
Dark Bronze Perforated	-	G8-994P	-
Garnet Red	G6-275	G8-275	-
Low Gloss Black	G6-892	G8-892	M2-892
Matte Alabaster	G6-991	G8-991	-
Matte Mushroom	G6-992	G8-992	-
Quartz	-	G8-1392	-
Rich Earth	-	G8-384	M2-384
Royal Navy	G6-685	G8-685	-
Sherwood Green	G6-590	G8-590	-
Snow Gloss	G6-110	G8-110	-
Sprig	G6-919	G8-919	-

For Premium Finishes, a surcharge will be applied. Please refer to the price chart for more information.

ORDERING KEY	
Style	Code
1"	G6+Color #

• Essentials (G6)

WIDTH TO:	24"	30"	36"	42"	48"	54"	60"	72"	84"	96"	108"	120"
HEIGHT TO:												
24"	\$175	183	195	208	227	250	261	322	330	373	537	676
30"	195	197	215	225	235	255	270	330	335	436	558	704
36"	212	221	229	244	251	271	273	336	356	445	591	751
48"	220	228	237	250	259	276	285	349	367	449	605	778
60"	223	234	248	260	270	289	301	366	391	465	654	804
72"	230	241	255	271	283	303	324	373	402	521	684	863
84"	287	306	326	343	362	376	405	462	498	608	758	938

Alta Aluminum blinds feature a deluxe integrated headrail, installed with hidden brackets or optional box brackets.

OPTIONS: EXTRA CHARGE	
• Channel Valance	add \$15
• Premium Finishes.....	add 10%

OPTIONS: NO EXTRA CHARGE	
• 2 On 1 Headrail (price as separate blinds)	
• Wand Control – either Left or Right	
• Hold-Down Brackets	
• Spacer Blocks	
• Tile Cut-Out (only available for blinds over 31", maximum width 1" on each side)	
• Optional Wand Lengths (refer to page 7)	
• Color Coordinated Installation Box Bracket (refer to page 6)	

SIZE SPECIFICATIONS - Essentials .006 Gauge	
Slat width	1"
Minimum width (NET)	10-1/2"
Minimum height	12"
Maximum width of a single blind	120"
Maximum height	84"
Maximum width with two on one headrail	144"
10-1/2" - 12-3/8" Center Tilt only (No Lift) 12-1/2" or greater L or R Tilt only	

ORDERING KEY	
Style	Code
1"	G8+Color #

• Prime (G8)

WIDTH TO:	24"	30"	36"	42"	48"	54"	60"	72"	84"	96"	108"	120"
HEIGHT TO:												
24"	\$235	243	255	268	287	310	321	382	369	433	597	736
30"	255	257	275	285	295	315	330	390	384	496	618	764
36"	272	281	289	304	311	331	333	396	416	505	651	811
48"	280	288	297	310	319	336	345	409	427	509	665	838
60"	283	294	308	320	330	349	361	426	451	525	714	864
72"	290	301	315	331	343	363	384	433	462	581	744	923
84"	347	366	386	403	422	436	465	522	558	668	818	998

Alta Aluminum blinds feature a deluxe integrated headrail, installed with hidden brackets or optional box brackets.

OPTIONS: EXTRA CHARGE	
• Channel Valance	add \$15
• Premium Finishes.....	add 10%

OPTIONS: NO EXTRA CHARGE	
• 2 On 1 Headrail (price as separate blinds)	
• Wand Control – either Left or Right	
• Hold-Down Brackets	
• Extension Brackets	
• Spacer Blocks	
• Tile Cut-Out (only available for blinds over 31", maximum width 1" on each side)	
• Optional Wand Lengths (refer to page 7)	
• Color Coordinated Installation Box Bracket (refer to page 6)	

SIZE SPECIFICATIONS - Prime .008 Gauge	
Slat width	1"
Minimum width (NET)	10-1/2"
Minimum height	12"
Maximum width of a single blind	120"
Maximum height	84"
Maximum width with two on one headrail	144"
10-1/2" - 12-3/8" Center Tilt only (No Lift) 12-1/2" or greater L or R Tilt only	

// Aluminum Blinds – Cordless Lift & Lock™



ORDERING KEY	
Style	Code
2"	M2+Color #

• Macro 2" with Channel Valance (M2)

WIDTH TO:	24"	30"	36"	42"	48"	54"	60"	72"	84"	96"	108"	120"
HEIGHT TO:												
24"	\$214	223	238	254	277	305	318	393	377	442	651	821
30"	238	240	262	275	287	311	329	403	395	519	677	855
36"	255	270	280	298	306	330	333	410	435	530	717	913
48"	263	278	289	304	315	337	348	426	448	534	734	946
60"	272	286	298	317	329	353	367	447	477	553	794	977
72"	276	294	311	330	346	369	395	455	491	622	831	1049
84"	350	373	398	419	441	458	494	564	607	728	921	1141

OPTIONS: EXTRA CHARGE
• Premium Finishes..... add 10%

OPTIONS: NO EXTRA CHARGE
<ul style="list-style-type: none"> • 2 On 1 Headrail (price as separate blinds) • Wand Control – either Left or Right • Hold-Down Brackets • Spacer Blocks • Tile Cut-Out (only available for blinds over 31", maximum width 1" on each side) • Optional Wand Lengths (refer to page 7)

SIZE SPECIFICATIONS - Macro .008 Gauge	
Slat width	2"
Minimum width (NET)	10-1/2"
Minimum height	12"
Maximum width of a single blind	120"
Maximum height	84"
Maximum width with two on one headrail	144"
10-1/2" - 12-3/8" Center Tilt only (No Lift) 12-1/2" or greater L or R Tilt only	

FEATURES AND OPTIONS

	Essentials Collection	Prime Collection	Macro Collection
	1"	1"	2"
# of Colors	36	46	20
Slat Gauge	0.006	0.008	0.008
Headrail Size	1-1/4" X 1-1/2"	1-1/4" X 1-1/2"	2-1/4" X 1-1/2"
Headrail Gauge	0.024	0.024	0.024
Bottomrail	1-1/2" x 1-1/8"	1-1/2" x 1-1/8"	2" x 1-1/8"
Cord Size	1.4 mm	1.4 mm	1.4 mm
Ladder Spacing	22 mm	22 mm	42 mm
Wand	Clear, Standard	Clear, Standard	Clear, Standard
OPTIONS			
2 on 1 Headrail	✓	✓	✓
Control Positions (L or R)	✓	✓	✓
Box Brackets	✓	✓	✓
Hidden Brackets	✓	✓	✓
Dust Resistant Finish	✓	✓	✓
Channel Valance	✓	✓	✓
Integrated Valance	✓	✓	✓
Heavy Duty Headrail	✓	✓	✓
Push Button Bottomrail	✓	✓	✓
Hold-down Brackets	✓	✓	✓
Spacer Blocks*	✓	✓	✓
Tile Cut-Out**	✓	✓	✓

* Used for outside mount blinds only to clear obstructions, such as window moldings.

** Tilt Cut-Outs are only available for blinds over 31", maximum 1" on each side.

INTEGRATED VALANCE



HIDDEN BRACKET INSTALLATION

Hidden Installation Brackets

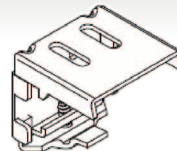

CHANNEL VALANCE



BOX BRACKET INSTALLATION

Box Installation Brackets

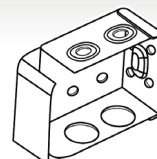

PRODUCT SPECIFICATIONS

SIZE SPECIFICATIONS	Essentials / Prime Collections		Macro Collection
	1" .006 GAUGE / .008 GAUGE		2" .008 GAUGE
Slat width	1"		2"
Minimum width (NET)	10-1/2"		10-1/2"
Minimum height	12"		12"
Maximum width of a single blind	120"		120"
Maximum height	84"		84"
Maximum width 2 on 1 headrail	144"		144"
Center tilt only - Net Width	10 1/2" to 12-3/8"		10 1/2" to 12-3/8"
Left or right tilt only - Net width	12-1/2" or greater		12-1/2" or greater

FINISHED DIMENSIONS	1" .006 GAUGE / .008 GAUGE		2" .008 GAUGE
	Inside Mount (IB) Headrail	- 1/2"	
Inside Mount (IB) Slat	- 1/2"		- 1/2"
Outside Mount (OB) Headrail	Ordered Width		- 1/4"
Outside Mount (OB) Slat	Ordered Width		Ordered Width
Blind Height	Ordered Height		Ordered Height

**NOTE: Measurements represent difference of total headrail or slat width (including endcaps) from ordered width

MOUNTING REQUIREMENTS	1" .006 GAUGE / .008 GAUGE			2" .008 GAUGE		
	Inside Mount Minimum Depth	Inside Mount Flush	Outside Mount (Wall Surface)	Inside Mount Minimum Depth	Inside Mount Flush	Outside Mount (Wall Surface)
No Valance						
Hidden Bracket	7/8"	1-3/4"	5/8"	n/a	n/a	n/a
Box Bracket	1"	1-3/4"	1-3/8"	n/a	n/a	n/a
With Valance						
Hidden Bracket	7/8"	2-1/4"	5/8"	n/a	n/a	n/a
Box Bracket	1"	2-1/4"	1-3/8"	1-1/8"	2-7/8"	1-3/4"

STACKING HEIGHTS	1" .006 GAUGE / .008 GAUGE		2" .008 GAUGE
	Blind Height		
Stacks to:			
36"	3-7/8"		5-1/4"
48"	4-1/4"		5-1/2"
60"	4-5/8"		5-3/4"
72"	5"		6"
84"	5-3/8"		6-1/4"

Return Lengths	1" .006 GAUGE / .008 GAUGE		2" .008 GAUGE
	Inside Mount	No Returns	
Outside Mount	1-3/4"		2-7/8"

WAND LENGTHS

1" Blinds	
Wand Length	Blind Height
12"	12" to 22"
20"	22-1/8" to 37"
30"	37-1/8" to 52"
40"	52-1/8" to 67"
50"	67-1/8" to 82"
60"	82-1/8" to 84"

Optional Lengths: 70", 78", 90"

2" Blinds	
Wand Length	Blind Height
12"	12" to 24"
20"	24-1/8" to 36"
24"	36-1/8" to 48"
36"	48-1/8" to 60"
48"	60-1/8" to 75"
60"	75-1/8" to 84"

Optional Lengths: 72" and 84"

LADDER PLACEMENT

1" Blinds	
Finished Width	# of Ladders
Up to 36"	2
36-1/8" to 60"	3
60-1/8" to 84"	4
84-1/8" to 108"	5
108-1/8" to 120"	6

2" Blinds	
Finished Width	# of Ladders
Up to 46-1/2"	2
46-5/8" to 80-1/2"	3
80-5/8" to 114-1/2"	4
114-5/8" to 120"	5

CONTROL LOCATIONS

1" Metals	Width (Net)	Single Blind	2 on 1 (Left Blind)	2 on 1 (Right Blind)
	10-1/2" to 12-3/8"	C (Only)	C (Only)	C (Only)
12-1/2" or greater	L or R			

2" Metals	Width (Net)	Single Blind	2 on 1 (Left Blind)	2 on 1 (Right Blind)
	10-1/2" to 12-3/8"	Center Tilt Only	C (Only)	C (Only)
12-1/2" or greater	L or R			

CORDLESS LIFT & LOCK™ BOTTOMRAIL COLOR CHART



The Cordless Lift & Lock™ operating system comes with a coordinating aluminum bottomrail in the color listed below.

NOTE: Color matched metal blinds are made of a variety of materials, extruded aluminum, rolled steel and several different plastics. Colors can differ slightly between the different materials.

COLOR NAME	1" Blinds				2" Blinds		
	Cordless Lift & Lock Bottomrail		Cordless Lift & Lock Bottomrail		Cordless Lift & Lock Bottomrail		
Solid Finishes	1" .006 GAUGE	1" .008 GAUGE	Color	Color #	2" .008 GAUGE	Color	Color #
Alabaster	G6-002	G8-002	Alabaster	002	M2-002	Alabaster	002
Antique	G6-973	G8-973	Alabaster	002	M2-973	Antique White	973
Beige	G6-186	G8-186	Beige	186	-		
Black	G6-048	G8-048	Black	048	M2-048	Black	048
Canvas	G6-830	G8-830	Alabaster	002	M2-830	Alabaster	002
Cashmere	G6-997	G8-997	Cashmere / Silver Cloud	318	-		
Chalk White	G6-885	G8-885	Gloss White	110	M2-885	Chalk White / Flex White	885
Dark Bronze	G6-994	G8-994	Bronze	064	M2-994	Bronze	064
Evening Snow	-	G8-385	Pearl / Linen Flirt	127	-		
Malibu Sand	G6-316	G8-316	Malibu Sand	449	-		
Mercury	G6-276	G8-276	Mercury	276	M2-276	Silverado	276
Mushroom	G6-365	G8-365	Mushroom	478	M2-365	Mushroom	476
Pearl	G6-974	G8-974	Pearl / Linen Flirt	127	M2-974	Antique White	973
Pebble	G6-999	G8-999	Pebble	999	-		
Pewter Gray	G6-405	G8-405	Pebble	999	-		
Polar Bear	G6-116	G8-116	Snow Gloss White	110	M2-116	Chalk White / Flex White	885
Pure White	G6-125	G8-125	Pure White / White	125	-		
Raw Umber	G6-887	G8-887	Raw Umber / Umber	820	M2-887	Bronze	064
Sand	G6-310	G8-310	Sand / Fawn	205	M2-310	Sand / Fawn	205
Seattle Gray	G6-860	G8-860	Seattle Gray	860	-		
Smokey Gray	G6-443	G8-443	Squirrel Gray	426	-		
Squirrel Gray	G6-998	G8-998	Squirrel Gray	426	M2-998	Squirrel Gray	426
U.N. Gray	-	G8-870	U.N Gray / Dark Gray	039	M2-870	Dark Gray	396
Vanilla	-	G8-148	Alabaster	002	M2-148	Alabaster	002
White	G6-990	G8-990	Snow Gloss White	110	M2-990	Chalk White / Flex White	885
White Cap	G6-113	G8-113	Pearl / Linen Flirt	127	-		
Premium Finishes	1" .006 GAUGE	1" .008 GAUGE	Color	Color #	2" .008 GAUGE	Color	Color #
Bright Aluminum	G6-190	G8-190	Bright Aluminum	058	M2-190	Natural	058
Brushed Aluminum	G6-034	G8-034	Bright Aluminum	058	M2-034	Natural	058
Brushed Aluminum Perforated	-	G8-034P	Bright Aluminum	058	-		
Brushed Nickel Texture	-	G8-262	Bright Aluminum	058	-		
Brushed Patina	G6-996	G8-996	Brushed Patina	996	-		
Café Noir	G6-993	G8-993	Café Noir	993	-		
Champagne Mist	-	G8-995	Champagne Mist	995	-		
China Blue	G6-637	G8-637	China Blue	395	-		
Copperite	-	G8-915	Copperite	915	-		
Dark Bronze Perforated	-	G8-994P	Bronze	064	-		
Garnet Red	G6-275	G8-275	Garnet Red	448	-		
Low Gloss Black	G6-892	G8-892	Black	048	M2-892	Black	048
Matte Alabaster	G6-991	G8-991	Alabaster	002	-		
Matte Mushroom	G6-992	G8-992	Mushroom	478	-		
Quartz	-	G8-1392	White	125	-		
Rich Earth	-	G8-384	Rich Earth / Milk Chocolate	097	M2-384	Rich Earth / Milk Chocolate	097
Royal Navy	G6-685	G8-685	Royal Navy / Blue Blue	181	-		
Sherwood Green	G6-590	G8-590	Sherwood Green / Hunter Green	413	-		
Snow Gloss	G6-110	G8-110	Gloss White	110	-		
Sprig	G6-919	G8-919	Sprig / Julep	919	-		

NOTE: Bottomrail colors are pre-selected. Hardware color override is not available.



1-888-523-2611

customer.service@midwestdesignersupply.com